

1st June 2020

Dear EAGC Members and Stakeholders,

**WEEKLY UPDATE ON THE COVID-19 PANDEMIC FOR THE GRAIN SECTOR IN EASTERN AFRICA - WEEK 10**

Greetings from the Secretariat.

This Communique is a continuation of our weekly updates to EAGC Members and Stakeholders on developments in the grain sector in Eastern Africa in the face of the Novel Coronavirus (COVID-19). Previous editions of this Communique are accessible [here](#).

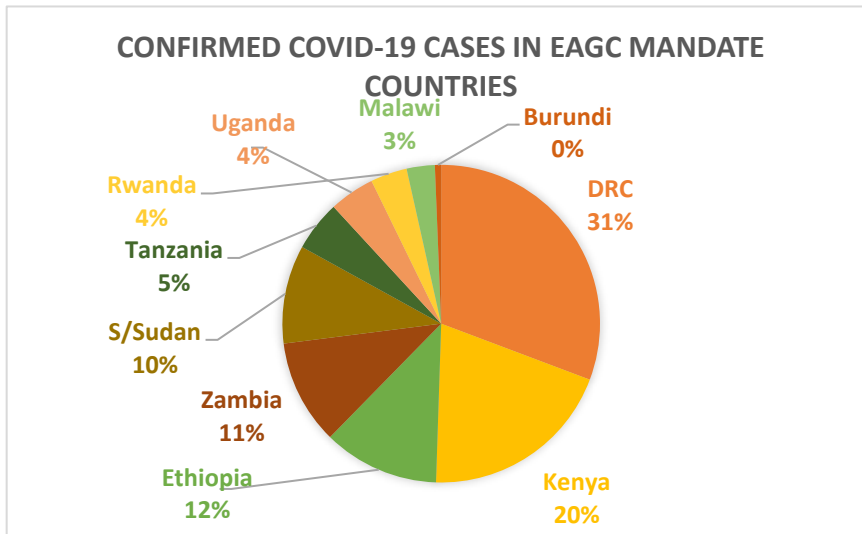

The number of Covid-19 confirmed cases in EAGC mandate countries has risen to 9917 in the last one week, a 51% rise, indicating a reduction of increasing cases compared to last week.

Despite the various measures that have been put in place,

Source: WHO database as of 1st June 2020

projection of the current trends indicate that virus is likely to spread further and likely to have significant impact on the economy, food security and livelihoods. Countries have shifted their perceptives of the pandemic and are gradually adjusting to reboot their economies as they acclimatize with the virus.

Figure 1: Weekly progression of Covid-19 Cases in Eastern Africa

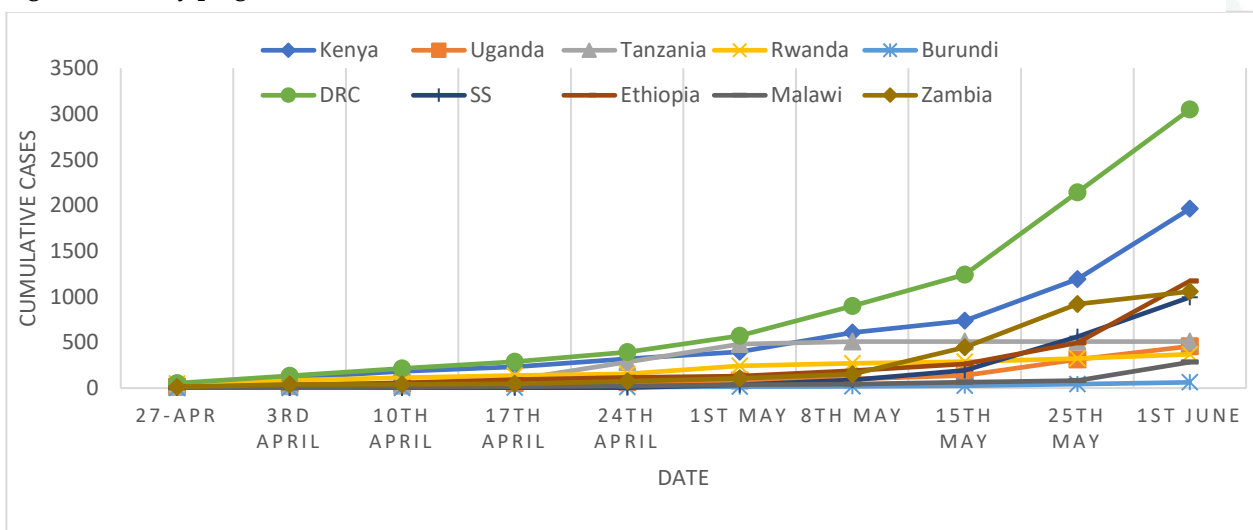

Source: WHO database as of 1st June 2020

**KENYA**  
Mbaazi Avenue, Off King'ara Road  
P.O. Box 218 – 00606, NAIROBI  
Tel: +254 (0) 20-374 5840  
Cell:+254-733 444 035 / 710 607 313

**TANZANIA**  
Plot No. 33, Mikocheni B,  
Daima Street Block A  
P.O. Box 33619 DAR ES SALAAM  
Tel: +255 754 354 582

**UGANDA**  
Muyenga, Galukande Close  
opp. Kironde Road  
P.O. Box 28435 KAMPALA  
Tel: +256 393 112 854

**RWANDA**  
Mulindi Grain Market-Office No. 69,  
Nyakagenzi Village- Ndera Sector  
P.O. Box 4497 KIGALI  
Tel: +250 788 313 998 / 788 315 138

**SOUTH SUDAN**  
Hai Amarat, Dehavana Lounge,  
P.O. Box 505 JUBA  
Tel: +211 955 031 334

E-mail: [grains@eagc.org](mailto:grains@eagc.org)  
[www.eagc.org](http://www.eagc.org) / [www.ratin.net](http://www.ratin.net)  
[www.grain.institute](http://www.grain.institute)  
[www.g-soko.com](http://www.g-soko.com)

C/o Tanzania Agriculture Research Institute,  
(TARI) Selian Centre,  
Dodoma Road, Opposite Arusha Airport  
P.O Box 6024, ARUSHA  
Tel: +255 677 058 378

**BURUNDI**  
C/o IFDC Office  
Tel: +257 714 80983  
BUJUMBURA

**MALAWI**  
P.O. Box 30209 LILONGWE, MALAWI  
Tel: +265 999 975 994/999 975 899

**ZAMBIA**  
C/o Grain Traders Association of Zambia  
Suite C & 1 Stand No. 6980, Katanga Road  
P.O. Box 34863 INDUSTRIAL AREA, LUSAKA  
Tel: +260 973 502 988

## A. New Measures taken by Governments in Eastern Africa

### Regional COVID-19 response

The EAC Secretariat has commenced the capacity building of staff at the eight international airports in the region as part of its implementation of the EAC Regional COVID-19 Response Plan, facilitated by the German Government. The first training of trainers (TOT) has started at the Jomo Kenyatta International Airport in Nairobi, Kenya. The training exercise is focusing on the prevention of and response to the spread of COVID-19 ahead of Partner States resuming their flight schedules.

The two 2-day courses will follow in Mombasa, Juba, Entebbe, Bujumbura, Dar es Salaam, Kilimanjaro and Kigali, and are organized and coordinated by the Civil Aviation Safety and Security Oversight Agency (EAC CASSOA) and implemented by AMREF Flying Doctors. The training targets a total of 240 key airport personnel who are expected to spearhead the development and conduction of targeted training sessions for the rest of the airport personnel.



#### Tanzania

- No new measures have been instituted in the week.
- According to the [Media reports](#), the Prime Minister said that only a handful of Coronavirus patients remained in Dar es Salaam, Kibaha and Dodoma.
  - Secondary schools, universities and sports events are expected to resume in June.



#### Uganda

- Following the directives to allow Private Vehicles to begin operating while observing MOH guidelines, there has been a significant increase in the number of vehicles in the Kampala Metropolitan Area.
- Stickers that were previously issued to Essential Workers are no longer in use, but motorists are advised to keep them for future purposes. Therefore, the Traffic Rules and Regulations are applicable to every motorist.



#### Rwanda

The government has reviewed and upheld the existing measures effective 2<sup>nd</sup> June, 2020, which will be further reviewed after 15 days upon a health assessment, as follows:

- Public and private businesses to continue with essential staff while other employees work from home
- Non-contact outdoor sports are permitted. The Ministry of sports will share detailed guidelines.
- Mottos are permitted to carry passengers except in Rusizi and Rubavu Districts
- Public and private transport between provinces shall resume except movement to and from Rusizi and Rubavu Districts. Transport of goods and cargo will continue with no more than two people onboard.
- Borders will remain closed, except for goods and cargo, as well as returning Rwandan citizens and legal residents. All returnees will be subjected to mandatory at their own cost.



#### Malawi

No new developments have taken place in the past week. Previous measures remain in place

- The wearing of masks is now compulsory for vendors and buyers in all markets in Lilongwe effective 18<sup>th</sup> May, 2020.

#### KENYA

Mbaazi Avenue, Off King'ara Road  
P.O. Box 218 – 00606, NAIROBI  
Tel: +254 (0) 20-374 5840  
Cell+254-733 444 035 / 710 607 313

E-mail: [grains@eagc.org](mailto:grains@eagc.org)  
[www.eagc.org](http://www.eagc.org) / [www.ratin.net](http://www.ratin.net)  
[www.grain.institute](http://www.grain.institute)  
[www.g-soko.com](http://www.g-soko.com)

#### TANZANIA

Plot No. 33, Mikocheni B,  
Daima Street Block A  
P.O. Box 33619 DAR ES SALAAM  
Tel: +255 754 354 582

C/o Tanzania Agriculture Research Institute,  
(TARI) Selian Centre,  
Dodoma Road, Opposite Arusha Airport  
P.O. Box 6024, ARUSHA  
Tel: +255 677 058 378

#### UGANDA

Muyenga, Galukande Close  
opp. Kironde Road  
P.O. Box 28435 KAMPALA  
Tel: +256 393 112 854

#### BURUNDI

C/o IFDC Office  
Tel: +257 714 80983  
BUJUMBURA

#### RWANDA

Mulindi Grain Market-Office No. 69,  
Nyakagenzi Village- Ndera Sector  
P.O. Box 4497 KIGALI  
Tel: +250 788 313 998 / 788 315 138

#### MALAWI

P.O. Box 30209 LILONGWE, MALAWI  
Tel: +265 999 975 994/999 975 899

#### SOUTH SUDAN

Hai Amarat, Dehavana Lounge,  
P.O. Box 505 JUBA  
Tel: +211 955 031 334

#### ZAMBIA

C/o Grain Traders Association of Zambia  
Suite C & 1 Stand No. 6980, Katanga Road  
P.O. Box 34863 INDUSTRIAL AREA, LUSAKA  
Tel: +260 973 502 988



## Kenya

In the past week, the 47 County Governments have addressed the following:

- Mapped 1.9 Million Households that require food support due to livelihood challenges related to COVID 19, out of which 742, 038 homes have been prioritized for food aid through cash transfer, e-voucher and in-kind food distribution. Nine (9) County Governments have mobilized 1.087 Billion to support this initiative. The National Government has supported 250,000 households in 10 counties
- Supporting farmers whose crops have been washed away by ongoing floods through provision of seeds for replanting and funds to reclaim their farms. Over 100,000 acres of land have washed away
- Commitment not to charge cess for the transportation of food stuff across the country

The Council of Governments has in the previous week noted the following:

- Adequate availability of cereals, pulses and fresh foods in the market and prices for most commodities remained stable.
- Prices of maize grain, wheat flour, rice and sugar recorded slight increase, due to increased sales during preparation for Bisulfite celebrations. Traders have sufficient stocks to meet the demand during this period.
- The supply of beans in the markets is still low and therefore the low availability in the markets is driving prices up by about 18% compared to the previous week.

## B. Updates on cross-border trade situation

Below is a highlight of situations at key borders in East Africa.



### Kenya/Tanzania borders

No new developments have been instituted in the past week.

Measures put in place by the ministerial bilateral meeting on free movement of goods at border posts between Kenya and Tanzania remain in place



### Tanzania/Uganda border

No new measures have been instituted in the past week.

- However, tighter controls remain in place at the Mutukula border as mass-testing for COVID-19 for all trucks entering Uganda from Tanzania is still ongoing.



### Tanzania/Rwanda border

- No new developments in the past week. EAGC continues to monitor the cross-border situation at the border point.

#### KENYA

Mbaazi Avenue, Off King'ara Road  
P.O. Box 218 – 00606, NAIROBI  
Tel: +254 (0) 20-374 5840  
Cell:+254-733 444 035 / 710 607 313

E-mail: [grains@eagc.org](mailto:grains@eagc.org)  
[www.eagc.org](http://www.eagc.org) / [www.ratin.net](http://www.ratin.net)  
[www.grain.institute](http://www.grain.institute)  
[www.g-soko.com](http://www.g-soko.com)

#### TANZANIA

Plot No. 33, Mikocheni B,  
Daima Street Block A  
P.O. Box 33619 DAR ES SALAAM  
Tel: +255 754 354 582

C/o Tanzania Agriculture Research Institute,  
(TARI) Selian Centre,  
Dodoma Road, Opposite Arusha Airport  
P.O Box 6024, ARUSHA  
Tel: +255 677 058 378

#### UGANDA

Muyenga, Galukande Close  
opp. Kironde Road  
P.O. Box 28435 KAMPALA  
Tel: +256 393 112 854

#### BURUNDI

C/o IFDC Office  
Tel: +257 714 80983  
BUJUMBURA

#### RWANDA

Mulindi Grain Market-Office No. 69,  
Nyakagenzi Village- Ndera Sector  
P.O. Box 4497 KIGALI  
Tel: +250 788 313 998 / 788 315 138

#### MALAWI

P.O. Box 30209 LILONGWE, MALAWI  
Tel: +265 999 975 994/999 975 899

#### SOUTH SUDAN

Hai Amarat, Dehavana Lounge,  
P.O. Box 505 JUBA  
Tel: +211 955 031 334

#### ZAMBIA

C/o Grain Traders Association of Zambia  
Suite C & 1 Stand No. 6980, Katanga Road  
P.O. Box 34863 INDUSTRIAL AREA, LUSAKA  
Tel: +260 973 502 988



### Uganda/Kenya borders

New measures have been put in place as follows:

- Truck drivers waiting to be tested have been diverted to the Busia Airstrip as a waiting bay, which is now fully occupied, creating a 6km stretch from the airstrip to the border.
- Return truck drivers from DRC, South Sudan and Northern Uganda are not allowed to pick backloads from Uganda to Kenya, with the trucks being escorted directly back to the border.
- A union representing Kenyan long-distance truck drivers has suspended the movement of trucks to Uganda until the Union is assured of the drivers' safety citing COVID-19 related harassment in Uganda.
- The long queues of trucks persist, creating a 50km stretch along the Bungoma Malabar highway. However, the traffic snarl-up is said to have been caused by rogue drivers who blocked the entry to the Malaba border point, as a protest to what they term as harassment at the border following the COVID - 19 screening procedures.



*A stretch of cargo trucks along the Eldoret-Malaba highway in Kenya, forcing truckers to camp in place Credit Source: Zenger*



*Trucks stuck in traffic at Malaba border on May 27, 2020. Source: Daily Nation*

### C. EAGC support to structured grain trade

EAGC also continues to facilitate trade in grains, farm inputs, equipment and services through the G-Soko and G-Hub systems as follows:

- Continued monitoring and regular reporting to Members on developments regarding the COVID-19 pandemic to inform the business decisions.
- Logistical support for grain trade using pre-qualified service providers.
- Emergency working capital arrangements with partner financial institutions ease liquidity constraints affecting the grain suppliers as a result of COVID-19.

EAGC encourages members to engage in the trade of the commodities offered in these latest grain trade catalogues showing [offers](#) and [enquiries](#) respectively.

#### KENYA

Mbaazi Avenue, Off King'ara Road  
P.O. Box 218 – 00606, NAIROBI  
Tel: +254 (0) 20-374 5840  
Cell:+254-733 444 035 / 710 607 313

E-mail: [grains@eagc.org](mailto:grains@eagc.org)  
[www.eagc.org](http://www.eagc.org) / [www.ratin.net](http://www.ratin.net)  
[www.grain.institute](http://www.grain.institute)  
[www.g-soko.com](http://www.g-soko.com)

#### TANZANIA

Plot No. 33, Mikocheni B,  
Daima Street Block A  
P.O. Box 33619 DAR ES SALAAM  
Tel: +255 754 354 582

C/o Tanzania Agriculture Research Institute,  
(TARI) Selian Centre,  
Dodoma Road, Opposite Arusha Airport  
P.O Box 6024, ARUSHA  
Tel: +255 677 058 378

#### UGANDA

Muyenga, Galukande Close  
opp. Kironde Road  
P.O. Box 28435 KAMPALA  
Tel: +256 393 112 854

#### BURUNDI

C/o IFDC Office  
Tel: +257 714 80983  
BUJUMBURA

#### RWANDA

Mulindi Grain Market-Office No. 69,  
Nyakagenzi Village- Ndera Sector  
P.O. Box 4497 KIGALI  
Tel: +250 788 313 998 / 788 315 138

#### MALAWI

P.O. Box 30209 LILONGWE, MALAWI  
Tel: +265 999 975 994/999 975 899

#### SOUTH SUDAN

Hai Amarat, Dehavana Lounge,  
P.O. Box 505 JUBA  
Tel: +211 955 031 334

#### ZAMBIA

C/o Grain Traders Association of Zambia  
Suite C & 1 Stand No. 6980, Katanga Road  
P.O. Box 34863 INDUSTRIAL AREA, LUSAKA  
Tel: +260 973 502 988

EAGC has held a G-SOKO online training and a subsequent G-Soko installation for one of her members; a Malawi based grain trading company, following a partnership to implement structured trading systems in Malawi. The training entailed an overview of G-SOKO as a trade solution by EAGC, G-SOKO operations, and virtual installation of G-SOKO onto the members' trade systems.

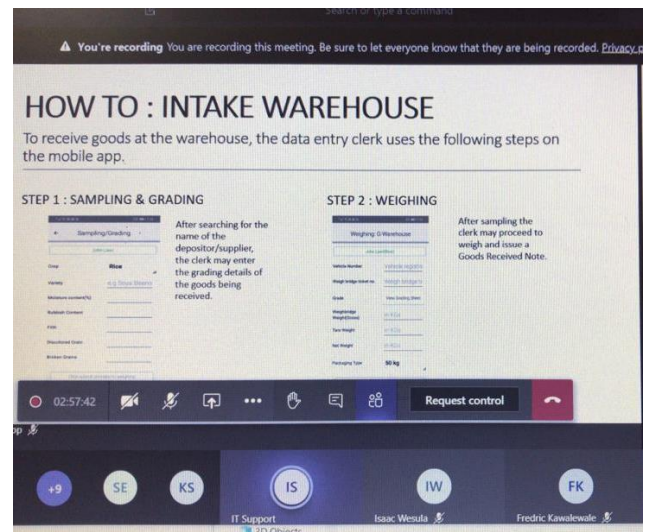
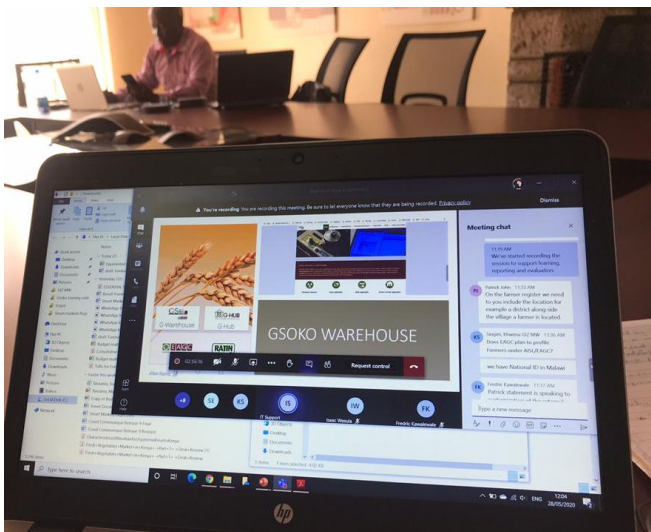

*Proceedings of the online based EAGC G-Soko Training to a Malawi based EAGC Member*

Noting the current restrictions to movement into or out of Nairobi Metropolitan Area, Mombasa, Kwale and Kilifi Counties, EAGC continues to **support its Members in Kenya to obtain travel authorization to or from these places**. Members requiring this service are encouraged to contact the Secretariat through the contacts provided in Annex 1 below.

**EAGC reminds its Members and Stakeholders to make use of its trade facilitation services and bring to its attention any disruptions they experience in either domestic or cross-border trade through Secretariat contacts at the end of this Communique (Annex 1).**

Thank you and God Bless you.

**Gerald Makau Masila,  
EXECUTIVE DIRECTOR,  
EASTERN AFRICA GRAIN COUNCIL**

**KENYA**  
Mbaazi Avenue, Off King'ara Road  
P.O. Box 218 – 00606, NAIROBI  
Tel: +254 (0) 20-374 5840  
Cell+254-733 444 035 / 710 607 313

**TANZANIA**  
Plot No. 33, Mikocheni B,  
Daima Street Block A  
P.O. Box 33619 DAR ES SALAAM  
Tel: +255 754 354 582

**UGANDA**  
Muyenga, Galukande Close  
opp. Kironde Road  
P.O. Box 28435 KAMPALA  
Tel: +256 393 112 854

**RWANDA**  
Mulindi Grain Market-Office No. 69,  
Nyakagenzi Village- Ndera Sector  
P.O. Box 4497 KIGALI  
Tel: +250 788 313 998 / 788 315 138

**SOUTH SUDAN**  
Hai Amarat, Dehavana Lounge,  
P.O. Box 505 JUBA  
Tel: +211 955 031 334

E-mail: [grains@eagc.org](mailto:grains@eagc.org)  
[www.eagc.org](http://www.eagc.org) / [www.ratin.net](http://www.ratin.net)  
[www.grain.institute](http://www.grain.institute)  
[www.g-soko.com](http://www.g-soko.com)

C/o Tanzania Agriculture Research Institute,  
(TARI) Selian Centre,  
Dodoma Road, Opposite Arusha Airport  
P.O Box 6024, ARUSHA  
Tel: +255 677 058 378

**BURUNDI**  
C/o IFDC Office  
Tel: +257 714 80983  
BUJUMBURA

**MALAWI**  
P.O. Box 30209 LILONGWE, MALAWI  
Tel: +265 999 975 994/999 975 899

**ZAMBIA**  
C/o Grain Traders Association of Zambia  
Suite C & 1 Stand No. 6980, Katanga Road  
P.O. Box 34863 INDUSTRIAL AREA, LUSAKA  
Tel: +260 973 502 988

**Annex 1: EAGC Contact Addresses for you to reach us for assistance**

Country	Contact Person	Contacts
Uganda	Justine Namubiru Country Program Officer	+256 772577500 <a href="mailto:jnamubiru@eagc.org">jnamubiru@eagc.org</a>
Kenya	Fred Simon Otieno Program Officer	+254 712 237 244 or call the office on +254 733, 444035 Email: <a href="mailto:fotieno@eagc.org">fotieno@eagc.org</a>
Tanzania	Kimwaga Mhando Trade Policy Manager and in-charge Tanzania Country Program	+255 712 453 493; +254 703 106 890 Email: <a href="mailto:kmhando@eagc.org">kmhando@eagc.org</a>
Rwanda	Epiphane Karekezi Country Program Officer	+250788750766 Email: <a href="mailto:ekarekezi@eagc.org">ekarekezi@eagc.org</a>
Malawi	Kohani Uzamba Country Program Officer	Mobile: +265 999 227 697 Email: <a href="mailto:ukohani@eagc.org">ukohani@eagc.org</a>
EAGC GSoko Trade Desk	Lynette Kithinji Trade Desk & Communications	+ 254 712 652 104 Email: <a href="mailto:communications@eagc.org">communications@eagc.org</a>
Regional office,	Gerald Makau Masila, Executive Director/CEO	+254 733 444055/ 0722 516250 Email: <a href="mailto:gmasila@eagc.org">gmasila@eagc.org</a>
DR Congo Burundi Zambia Ethiopia	Janet Ngombalu Regional Programs Coordinator	+254 722 804104 Email: <a href="mailto:jngombalu@eagc.org">jngombalu@eagc.org</a>  The Regional Office +254 733 444035, Email - <a href="mailto:grains@eagc.org">grains@eagc.org</a>



[www.gsoko.com](http://www.gsoko.com)



[www.grain.institute](http://www.grain.institute)



[www.ratin.net](http://www.ratin.net) - daily news updates



[www.eagc.org/services/atpaf-esa](http://www.eagc.org/services/atpaf-esa)

**KENYA**

Mbaazi Avenue, Off King'ara Road  
P.O. Box 218 – 00606, NAIROBI  
Tel: +254 (0) 20-374 5840  
Cell+254-733 444 035 / 710 607 313

E-mail: [grains@eagc.org](mailto:grains@eagc.org)  
[www.eagc.org](http://www.eagc.org) / [www.ratin.net](http://www.ratin.net)  
[www.grain.institute](http://www.grain.institute)  
[www.g-soko.com](http://www.g-soko.com)

**TANZANIA**

Plot No. 33, Mikocheni B,  
Daima Street Block A  
P.O. Box 33619 DAR ES SALAAM  
Tel: +255 754 354 582

C/o Tanzania Agriculture Research Institute,  
(TARI) Selian Centre,  
Dodoma Road, Opposite Arusha Airport  
P.O Box 6024, ARUSHA  
Tel: +255 677 058 378

**UGANDA**

Muyenga, Galukande Close  
opp. Kironde Road  
P.O. Box 28435 KAMPALA  
Tel: +256 393 112 854

**BURUNDI**

C/o IFDC Office  
Tel: +257 714 80983  
BUJUMBURA

**RWANDA**

Mulindi Grain Market-Office No. 69,  
Nyakagenzi Village- Ndera Sector  
P.O. Box 4497 KIGALI  
Tel: +250 788 313 998 / 788 315 138

**MALAWI**

P.O. Box 30209 LILONGWE, MALAWI  
Tel: +265 999 975 994/999 975 899

**SOUTH SUDAN**

Hai Amarat, Dehavana Lounge,  
P.O. Box 505 JUBA  
Tel: +211 955 031 334

**ZAMBIA**

C/o Grain Traders Association of Zambia  
Suite C & 1 Stand No. 6980, Katanga Road  
P.O. Box 34863 INDUSTRIAL AREA, LUSAKA  
Tel: +260 973 502 988